

*Compactness meets
High Power Density*

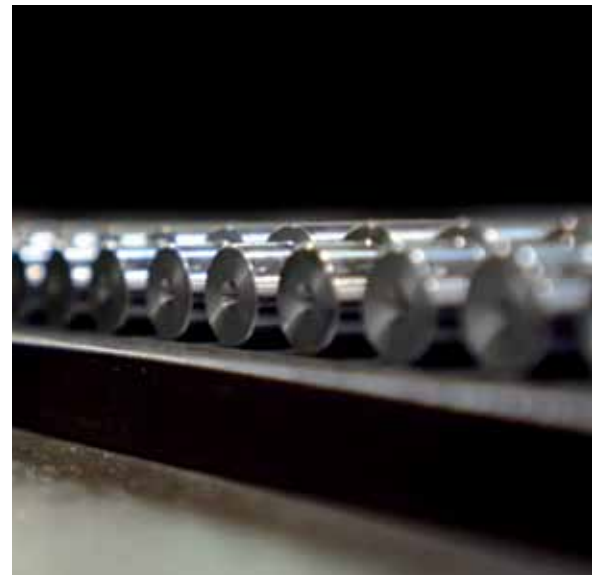

Single Stage Geared Motors

for Industrial Applications

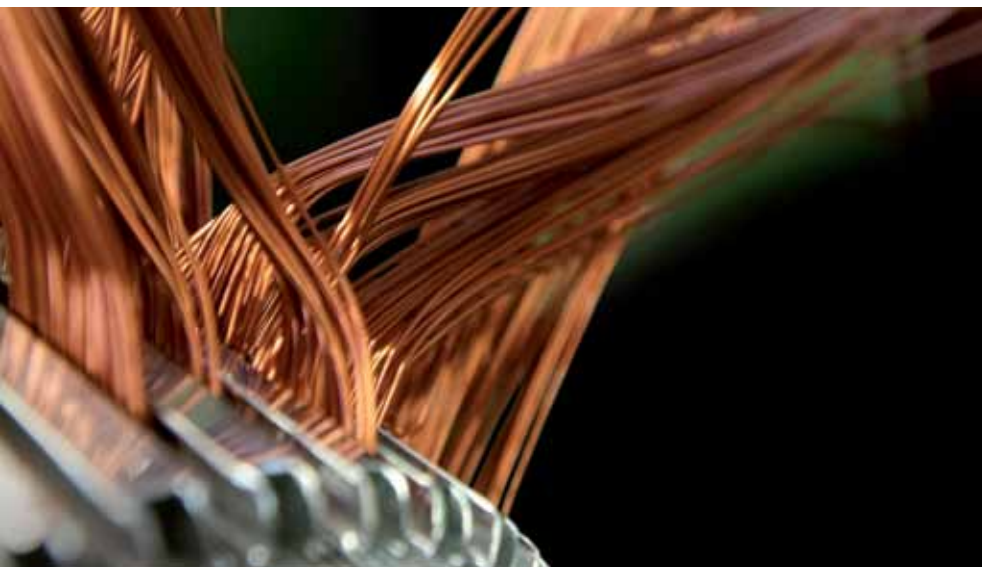

Modern and Efficient Drive Technology Single Stage Geared Motors

Advantages

- High efficiency ⇒ Economical energy consumption
- High quality helical gearing ⇒ Low noise and long life time
- Compact design ⇒ Small space requirement
- Aluminium housing ⇒ Low weight (assembly friendly) and corrosion resistance (painting not required)
- Variable installation options with different flanges ⇒ Optimum integration in customer machine and reduced installation effort
- Extended bearing clearance ⇒ Increase of maximum allowable radial forces
- Robust and virtually maintenance free



Technical Data

		MEDIUM-LINE	PREMIUM-LINE
Motor Type	AC Induction Motors	✓	✓
	Single Phase Motors		✓
	SINCHRON® Motors		✓
	Two Speed Motors		✓
	Number of poles	4-pole	2-, 4-, 6- and 8-pole
Motor Housing		Die cast	Extruded aluminum profile
Output Range		0,18 to 11 kW	
Torque Range		40 to 350 Nm	
Ventilation	Self ventilated	✓	✓
	Forced ventilation		✓
	Not ventilated		✓
Efficiency Class		IE3	Up to IE4
Brake (Holding or Operating Brake)			✓
Mains Operation		✓	✓
Inverter Operation		✓	✓
Inverter	Integrated (motor mounted)	✓	✓
	Stand alone (electrical panel mounted)	✓	✓
Protection Class		IP55 (Standard)	Up to IP66
Options	Encoder		✓
	X-class category 3 G+D		✓
	CCC, UL/CSA	✓	✓

Output Torque up to 40 Nm

Single Stage Helical Gearbox Type 1G41

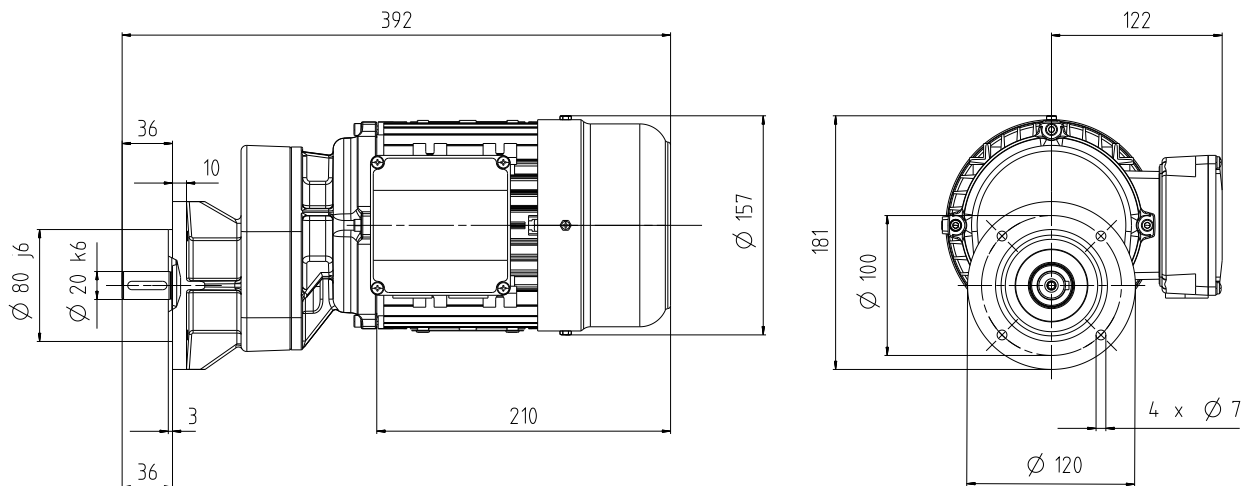
Dimension: 1G41F / MD80b-4

MEDIUM-LINE
PREMIUM-LINE

Frame Size	63 - 90	63 - 90
Output	0.25 - 1.5 kW	0.18 - 2.2 kW
Output Torque	T_{max} 40 Nm	
Output Speed	Asynchronous: 150 – 500 rpm Inverter controlled: variable from 500 rpm	
Available Shaft Designs	Solid shaft $\varnothing 20 \times 36$ mm; Special shaft design upon request	
Mounting Options	Standard flange design: B5 $\varnothing 120$ Optional: B5 with $\varnothing 140$ and 160 as well as B14 with $\varnothing 120, 140$ and 160 ; Foot mounting (upon request)	

i^*	n_2 [rpm]	n_1 [rpm]	P_{max} [kW]
9.556	146.5	1400	0.37
7.636	183.3	1400	0.55
7.000	200.0	1400	0.55
6.220	225.0	1400	0.75
5.818	240.6	1400	0.75
5.250	266.7	1400	1.1
4.357	321.3	1400	1.1
3.692	379.2	1400	1.5
2.947	475.1	1400	1.5
2.571	544.5	1400	1.5

* More gear ratios available upon request

Output Torque up to 70 Nm

Single Stage Helical Gearbox Type 1G71

Dimension: 1GF71 / MD80b-4

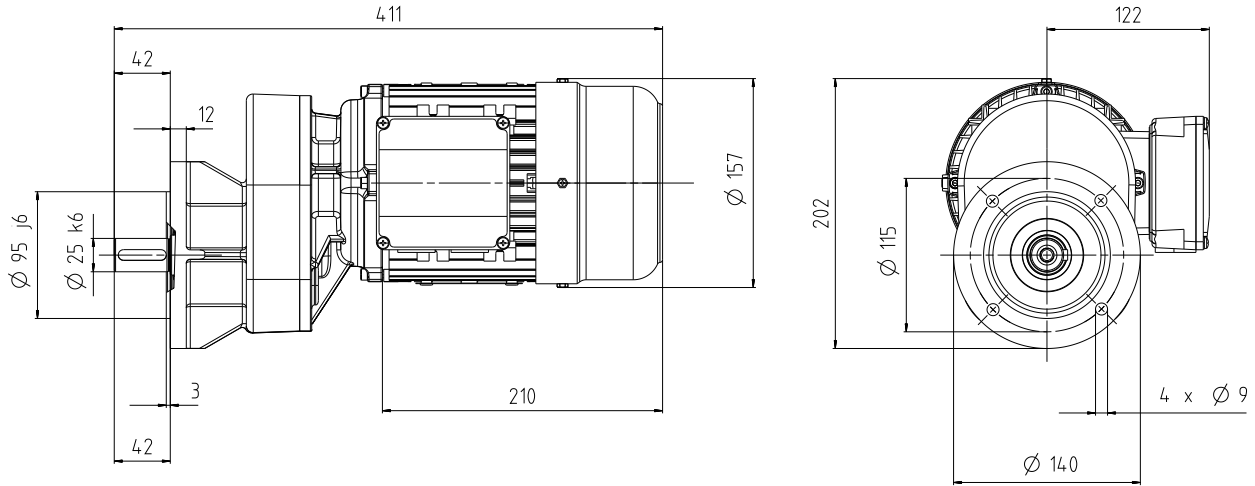

MEDIUM-LINE

PREMIUM-LINE

Frame Size	80 - 100	71 - 112
Output	0.55 - 3.0 kW	0.25 - 5.5 kW
Output Torque	T_{max} 70 Nm	
Output Speed	Asynchronous: 150 – 500 rpm Inverter controlled: variable from 500 rpm	
Available Shaft Designs	Solid shaft $\varnothing 20 \times 42$ mm; Special shaft design upon request	
Mounting Options	Standard flange design: B5 $\varnothing 140$ Optional: B5 with $\varnothing 160$ and 200 as well as B14 with $\varnothing 140, 160$ and 200 ; Foot mounting (upon request)	

i^*	n_2 [rpm]	n_1 [rpm]	P_{max} [kW]
9.300	150.5	1400	0.55
7.583	184.6	1400	0.75
7.000	200.0	1400	0.75
6.220	225.0	1400	1.1
5.818	240.6	1400	1.5
4.769	293.6	1400	2.2
3.846	364.0	1400	2.2
3.500	400.0	1400	2.2
3.200	437.5	1400	3.0
2.706	517.4	1400	3.0

* More gear ratios available upon request

Output Torque up to 120 Nm

Single Stage Helical Gearbox Type 1G121

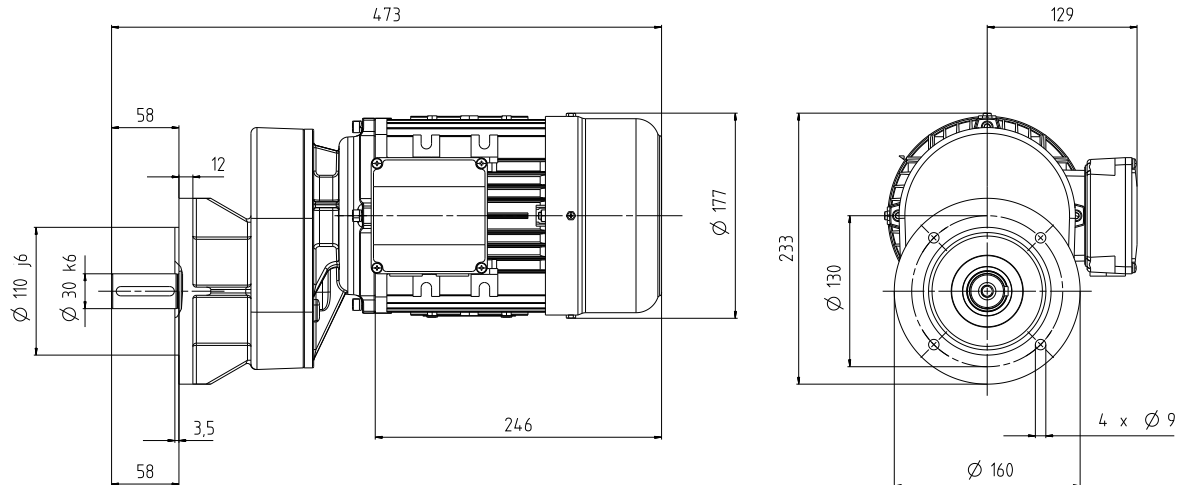
Dimension: 1G121F / MD90L-4

MEDIUM-LINE
PREMIUM-LINE

Frame Size	90 - 112	80 - 132
Output	1.1 - 4.0 kW	0.55 - 5.5 kW
Output Torque	T_{max} 120 Nm	
Output Speed	Asynchronous: 150 – 500 rpm Inverter controlled: variable from 500 rpm	
Available Shaft Designs	Solid shaft $\varnothing 30 \times 58$ mm; Special shaft design upon request	
Mounting Options	Standard flange design: B5 $\varnothing 160$ Optional: B5 with $\varnothing 200$ and 250 as well as B14 with $\varnothing 160, 200$ and 250 ; Foot mounting (upon request)	

i^*	n_2 [rpm]	n_1 [rpm]	P_{max} [kW]
9.333	150.0	1400	0.75
8.500	164.7	1400	1.1
7.000	200.0	1400	1.5
6.600	212.1	1400	1.5
5.909	236.9	1400	2.2
4.846	288.9	1400	3.0
4.182	344.8	1400	3.0
3.750	373.3	1400	4.0
3.471	403.3	1400	4.0
3.000	466.7	1400	4.0

* More gear ratios available upon request

Output Torque up to 200 Nm

Single Stage Helical Gearbox Type 1G201

Dimension: 1G201 / MD90L-4

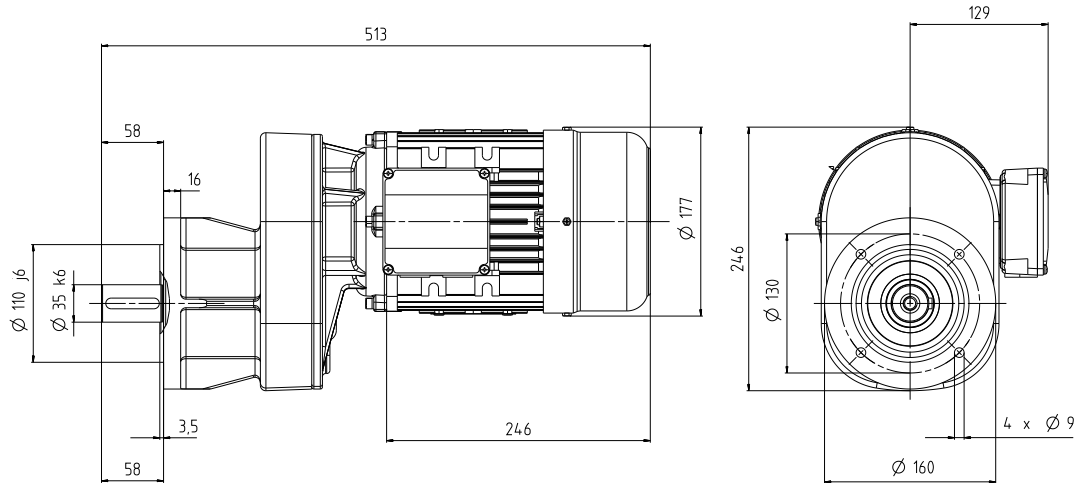

MEDIUM-LINE

PREMIUM-LINE

Frame Size	100 - 132	80 - 160
Output	2.2 - 7.5 kW	0.55 - 11.0 kW
Output Torque	T_{max} 200 Nm	
Output Speed	Asynchronous: 150 – 500 rpm Inverter controlled: variable from 500 rpm	
Available Shaft Designs	Solid shaft $\varnothing 35 \times 58$ mm; Special shaft design upon request	
Mounting Options	Standard flange design: B5 $\varnothing 160$ Optional: B5 with $\varnothing 200$ and 250 as well as B14 with $\varnothing 160, 200$ and 250 ; Foot mounting (upon request)	

i^*	n_2 [rpm]	n_1 [rpm]	P_{max} [kW]
9.769	143.3	1400	1.5
7.933	176.5	1400	2.2
6.714	208.5	1400	4.0
6.053	231.3	1400	4.0
5.353	261.5	1400	5.5
4.429	316.1	1400	5.5
3.750	373.3	1400	7.5
3.500	400.0	1400	7.5
3.100	450.0	1400	7.5
2.800	500.0	1400	7.5

* More gear ratios available upon request

Output Torque up to 350 Nm

Single Stage Helical Gearbox Type 1G351

Dimension: 1G351 / MD100Lb-4

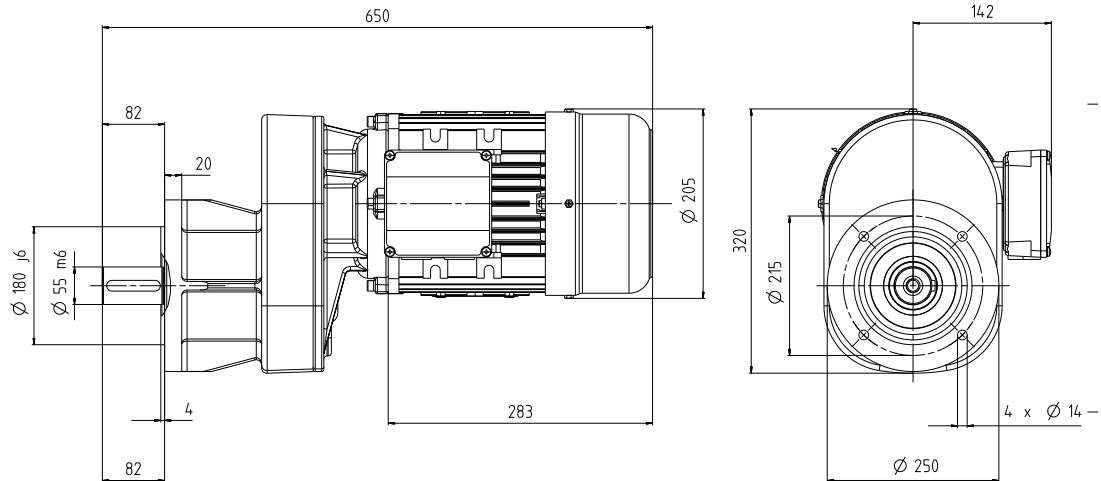

MEDIUM-LINE

PREMIUM-LINE

Frame Size	112 - 160	90 - 160
Output	4.0 - 11.0 kW	1.1 - 11.0 kW
Output Torque	T_{max} 350 Nm	
Output Speed	Asynchronous: 150 – 500 rpm Inverter controlled: variable from 500 rpm	
Available Shaft Designs	Solid shaft $\varnothing 45 \times 82$ mm; Special shaft design upon request	
Mounting Options	Standard flange design: B5 $\varnothing 200$ Optional: B5 with $\varnothing 250$ and 300 as well as B14 with $\varnothing 200, 250$ and 300 ; Foot mounting (upon request)	

i^*	n_2 [rpm]	n_1 [rpm]	P_{max} [kW]
9.167	152.7	1400	4.0
8.385	167.0	1400	5.5
6.615	211.6	1400	7.5
6.220	225.0	1400	7.5
5.692	246.0	1400	7.5
4.824	290.2	1400	7.5
4.118	340.0	1400	11.0
3.714	377.0	1400	11.0
3.100	450.0	1400	11.0
2.800	500.0	1400	11.0

* More gear ratios available upon request



We drive the world

A dense network of international subsidiaries and sales offices in all major industrial countries ensure close contact with our customers around the world – and guarantee an excellent standard of service.

Kindly contact us for further detailed information.

ABM Greiffenberger Antriebstechnik GmbH
P.O. Box 140, D-95614 Marktredwitz

Phone: +49 9231 67-0
Fax: +49 9231 67-5145

www.abm-drives.com
e-mail: info@abm-antriebe.de



member of **senata** - group